

















MONTAGEANLEITUNG

-  MONTAGEANLEITUNG
-  ASSEMBLY INSTRUCTION
-  DE INSTRUCTIE VAN DE ASSEMBLAGE
-  ISTRUZIONE DELL'ASSEMBLEA
-  INSTRUCCIÓN DE ASAMBLEA
-  INSTRUCTION DE MONTAGE
-  NÁVOD K MONTÁŽI
-  MONTERINGSANVISNING

-  MONTAJ TALIMATI
-  ASENNUSOHJE
-  BRUGSANVISNING
-  BRUKSANVISNING
-  UPUTE ZA MONTAŽU
-  NAVODILA ZA MONTAŽO
-  SZERELÉSI ÚTMUTATÓ
-  INSTRUCTIUNI DE MONTAJ



Modell-Nr.

12870

ART.-NR. FRONT KORPUS

12871  Silber

12872  Silber

12874  Silber

12877  Silber

12876  

Friedrich Küpper GmbH
Friedrich-Küpper-Weg
54570 Berlingen
Deutschland

Telefon +49 (0) 65 91 - 95 42 0
Telefax +49 (0) 65 91 - 95 42 17
E-Mail info@friedrich-kuepper-gmbh.de
Internet www.friedrich-kuepper-gmbh.de

EINZELTEILE / PIECES

A



1x

772 mm x 475 mm

B



1x

772 mm x 475 mm

F



2x

645 mm x 450 mm

K



1x

403 mm x 468 mm

L

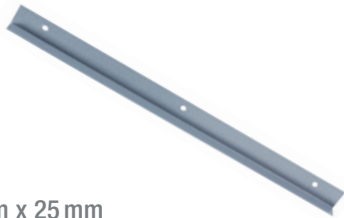

1x

400 mm x 25 mm

C



1x

1570 mm x 473 mm

D



1x

1570 mm x 473 mm

E

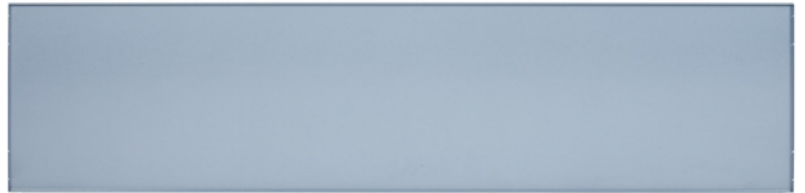

1x

1500 mm x 480 mm

Y



1x

1700 mm x 600 mm

H



9x

450 mm x 445 mm

I

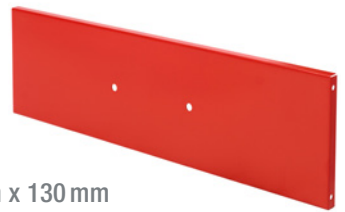

9x

470 mm x 130 mm

J



9x

450 mm x 120 mm

X



9x

450 mm x 20 mm

BEUTELINHALT / BAG CONTENT

 8x 5,5x19 mm	 18x KU 4x16 mm	 22x M5x10 mm	 22x ø5,3 mm	 22x M5	 72x M4 x 10 mm
 72x M4	 1x M6x16 mm	 1x ø6,4 mm	 1x M6	 1x 6x12 mm	 1x
 1x	 1x	 4x	 4x	 4x M8	 9x

BENÖTIGTES WERKZEUG / NEEDED TOOLS

<p>①</p>  <p>PH 1x100 PH 2x100 Schlitz 6,5x150</p>	<p>②</p>  <p>SW 7 SW 8 SW 10</p>	<p>③</p>  <p>4 mm</p>
<p>④</p> 	<p>⑤</p> 	<p>⑥</p>  <p>5 mm</p>
<p>⑦</p> 	<p>⑧</p> 	

1.



2. WICHTIG / IMPORTANT



3. WICHTIG / IMPORTANT

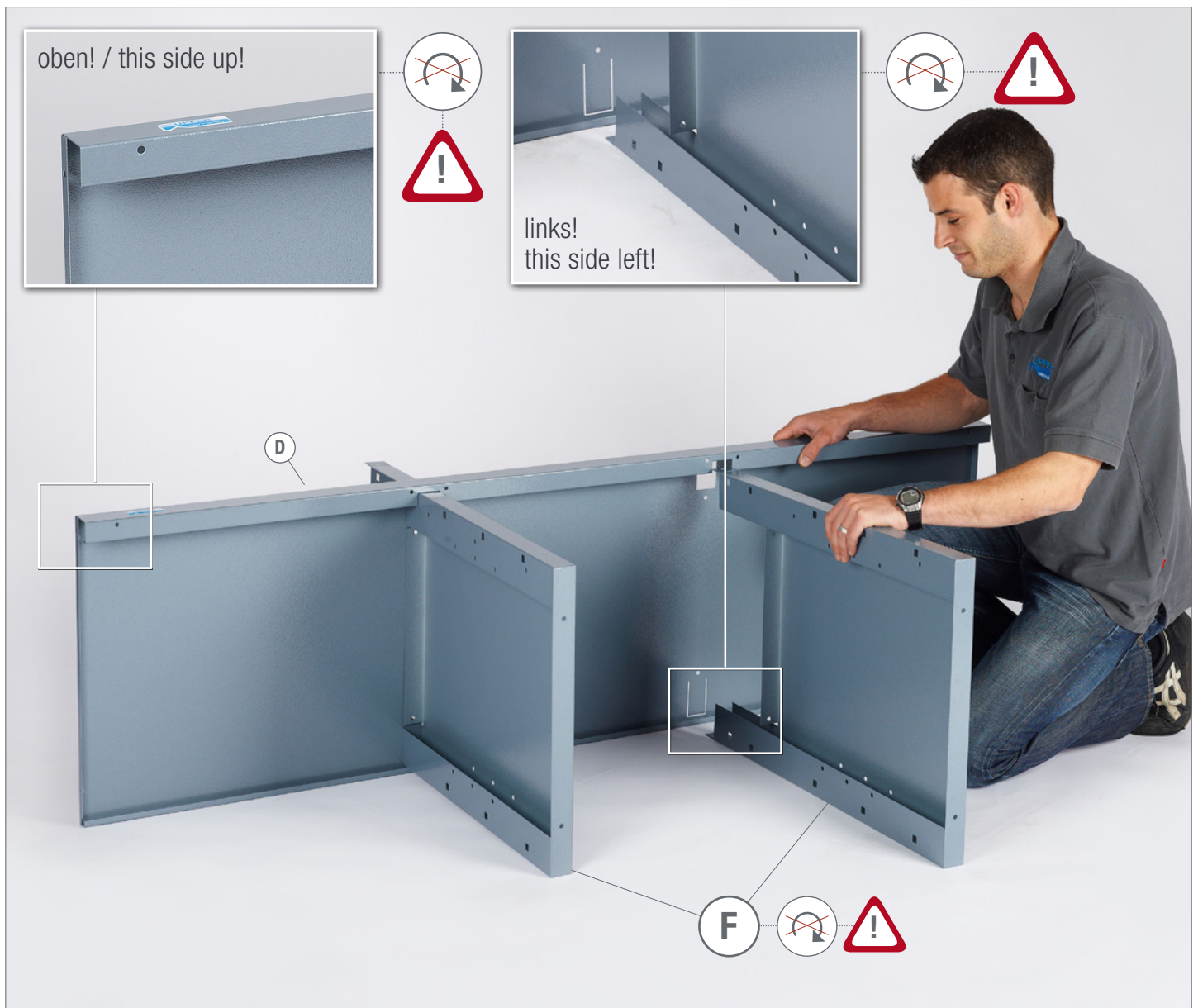

4.  4x M5  4x M5 x 10  4x 5,3MM

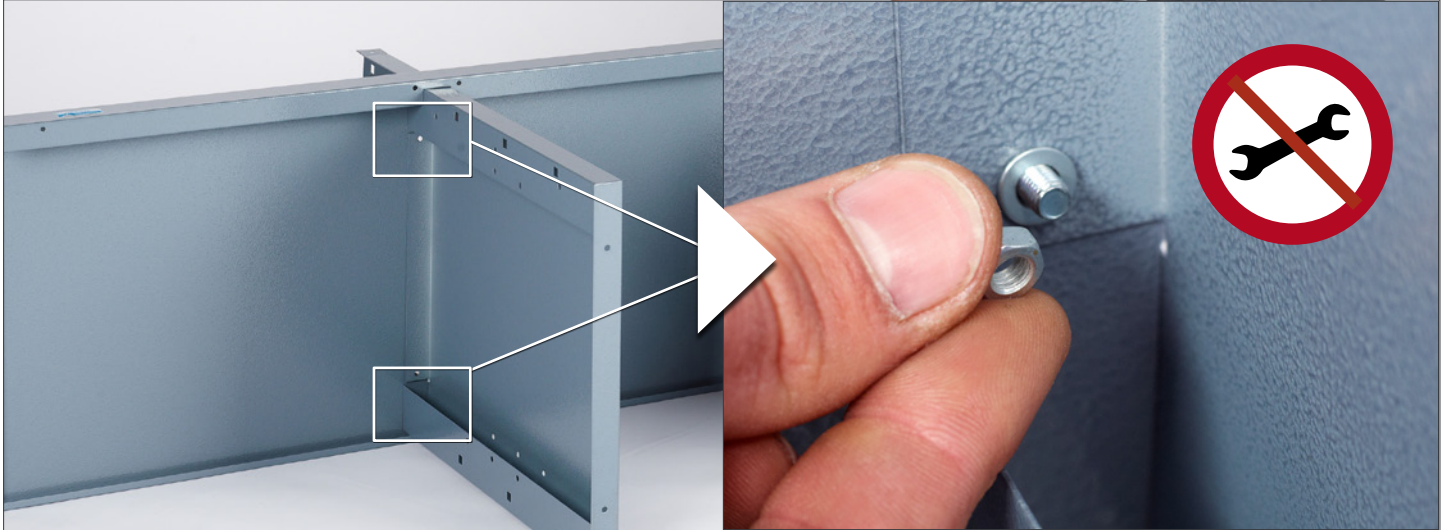

5.



6.  4x M5  4x M5 x 10  4x 5,3MM  2 SW 8  1 PH 2 X 100



7.



8.

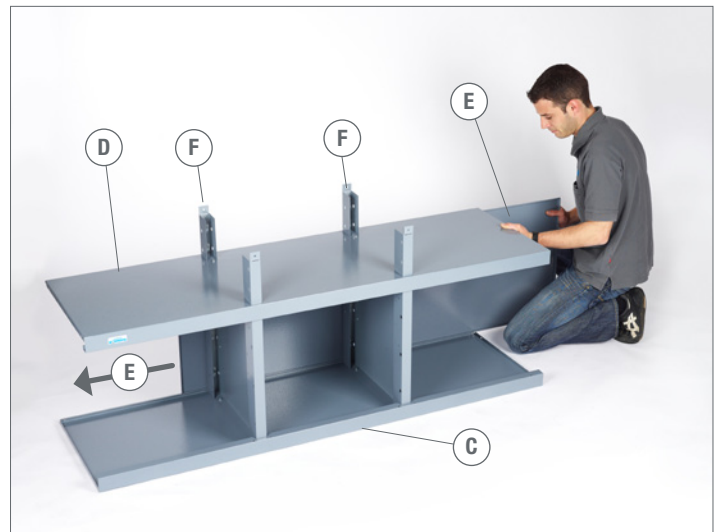

ZU SCHRITT 4. / IN ADDITION TO STEP 4.

②  SW 8 ①  PH 2x100

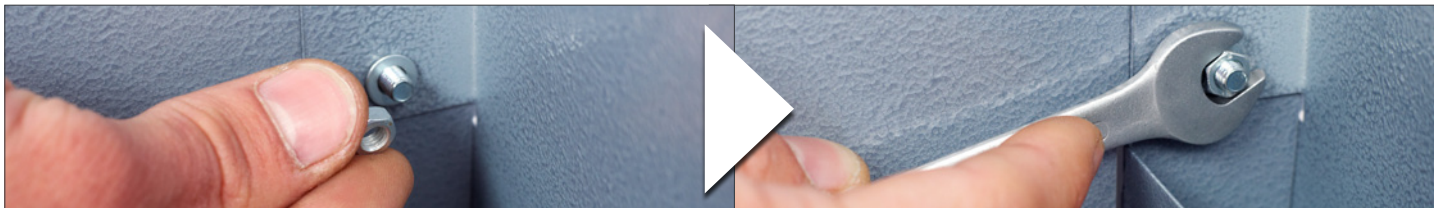

9. WICHTIG / IMPORTANT



10.  6x M5  6x M5 x 10  6x 5,3MM ②  SW 8 ①  PH 2x100



11.  6x M5  6x M5 x 10  6x 5,3MM ②  SW 8 ①  PH 2x100



12.

4x M8 4x 4x 4x

5

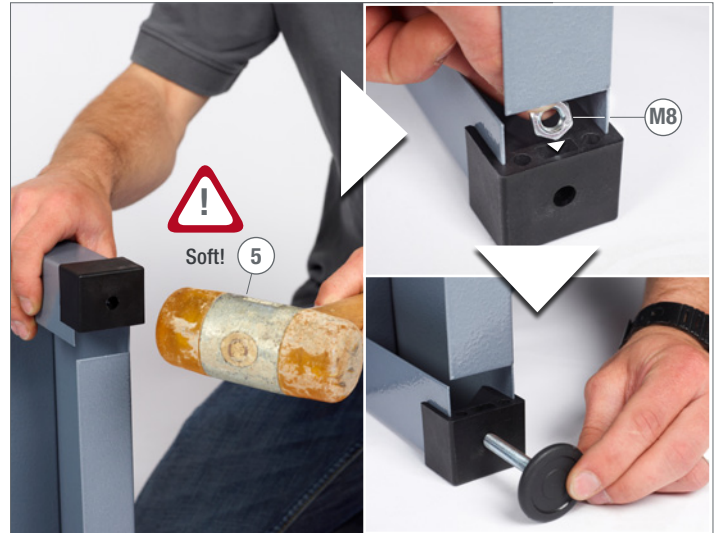

13.

2x M5 2x M5 x 10 2x 5,3 mm

2 SW 8 1 PH 2 x 100

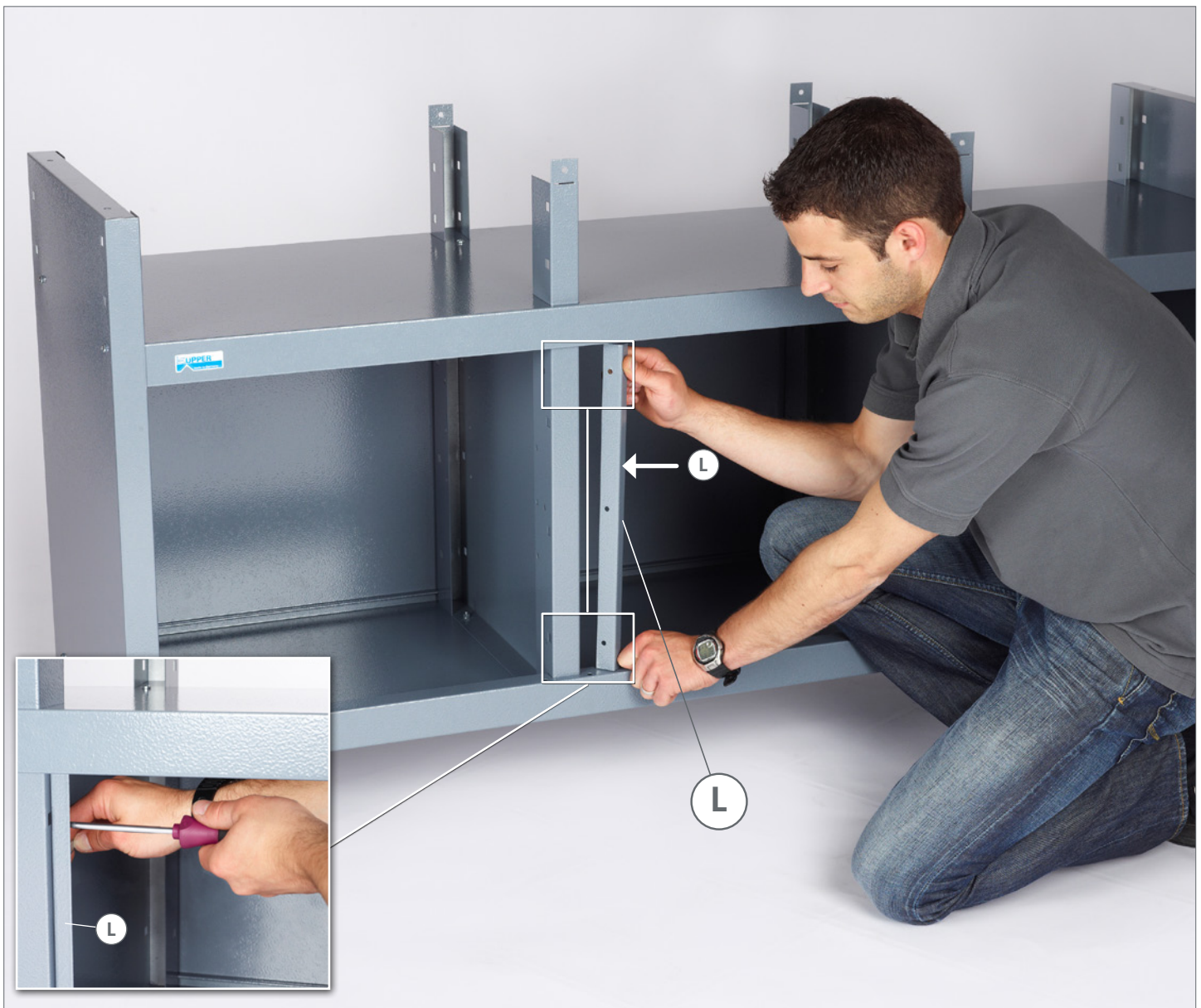

14.



15.

⑧ ⑦

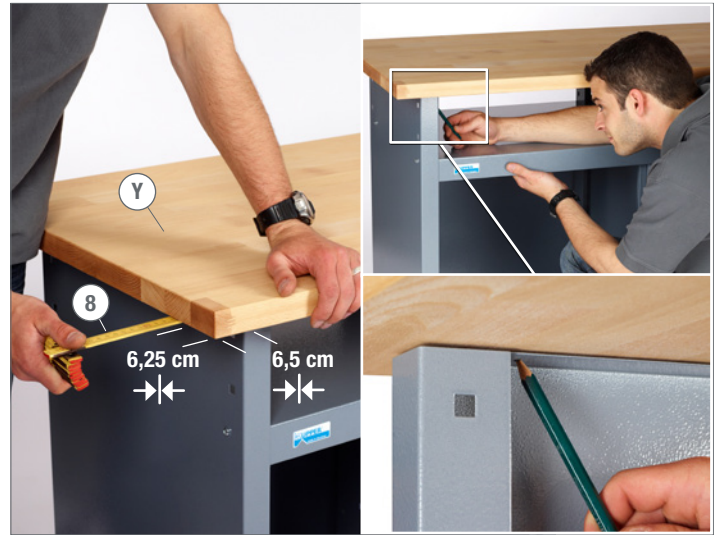

16.

④ ③



17.

8x 5,5 x 19 ② SW 8



18.

1x 1x 6x12

① Schlitz 6,5 x 150



19.



20.

1x M6 1x M6x16 1x 6,4 mm ② SW 10 ⑥



21.

1x 1x

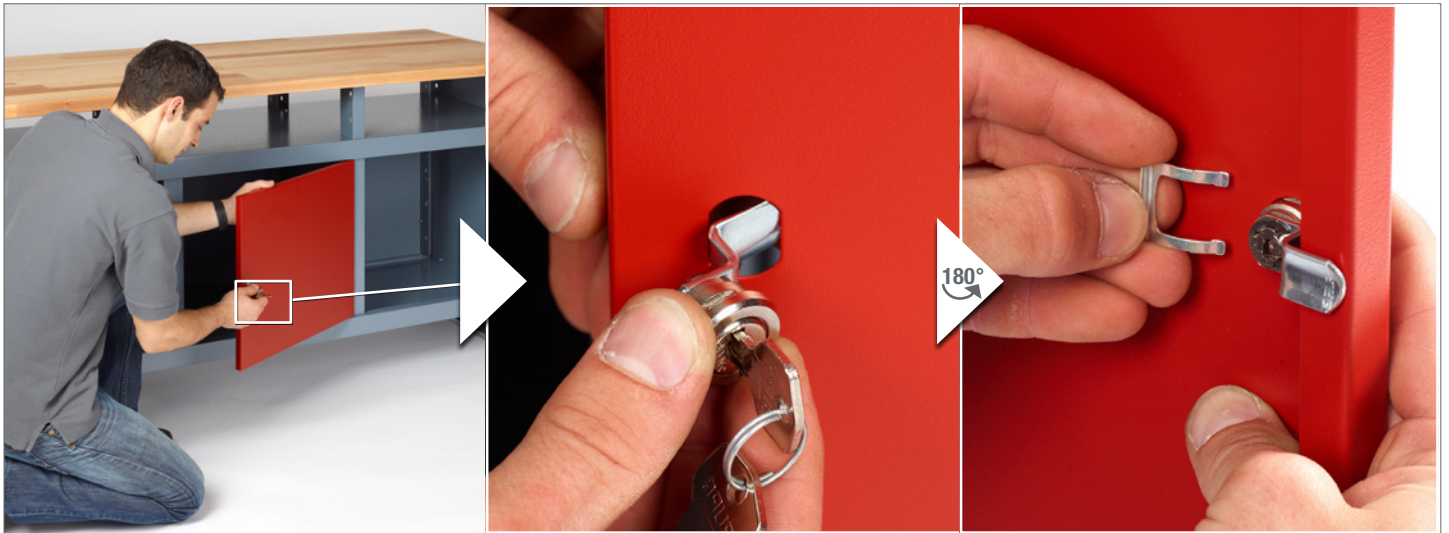

22.

⑩ 9x CR



23.

⑩ 9x CL



24.

18x M4

18x M4x10

② SW7

① PH1x100

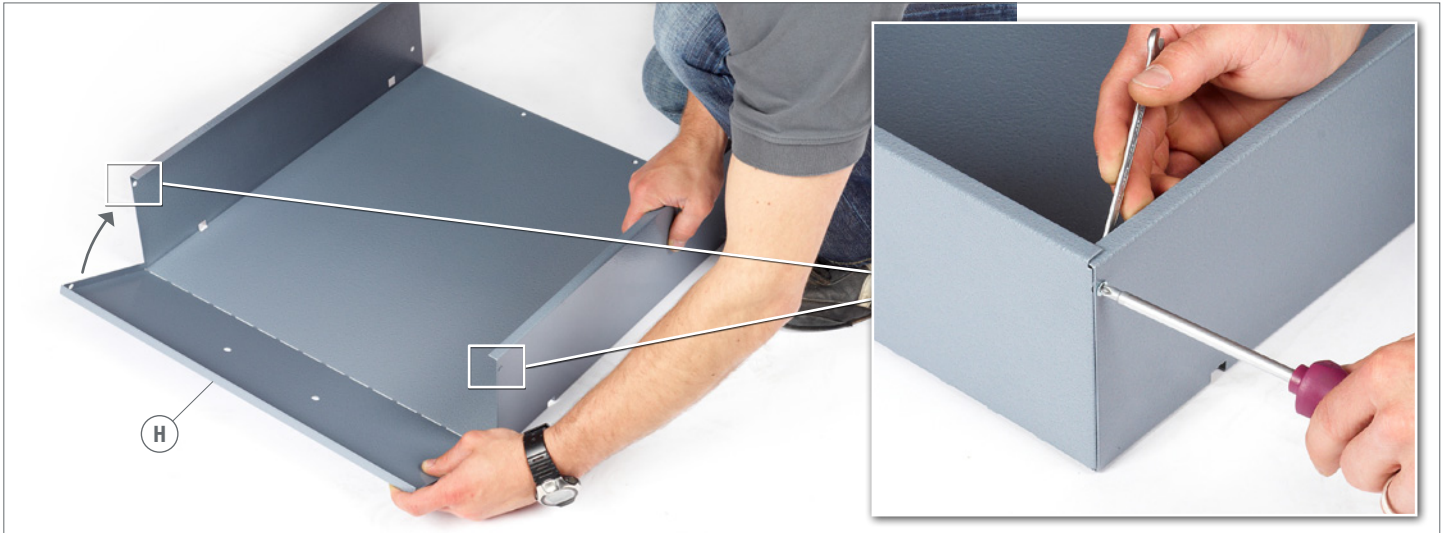

25.

54x M4

54x M4x10

② SW7

① PH1x100

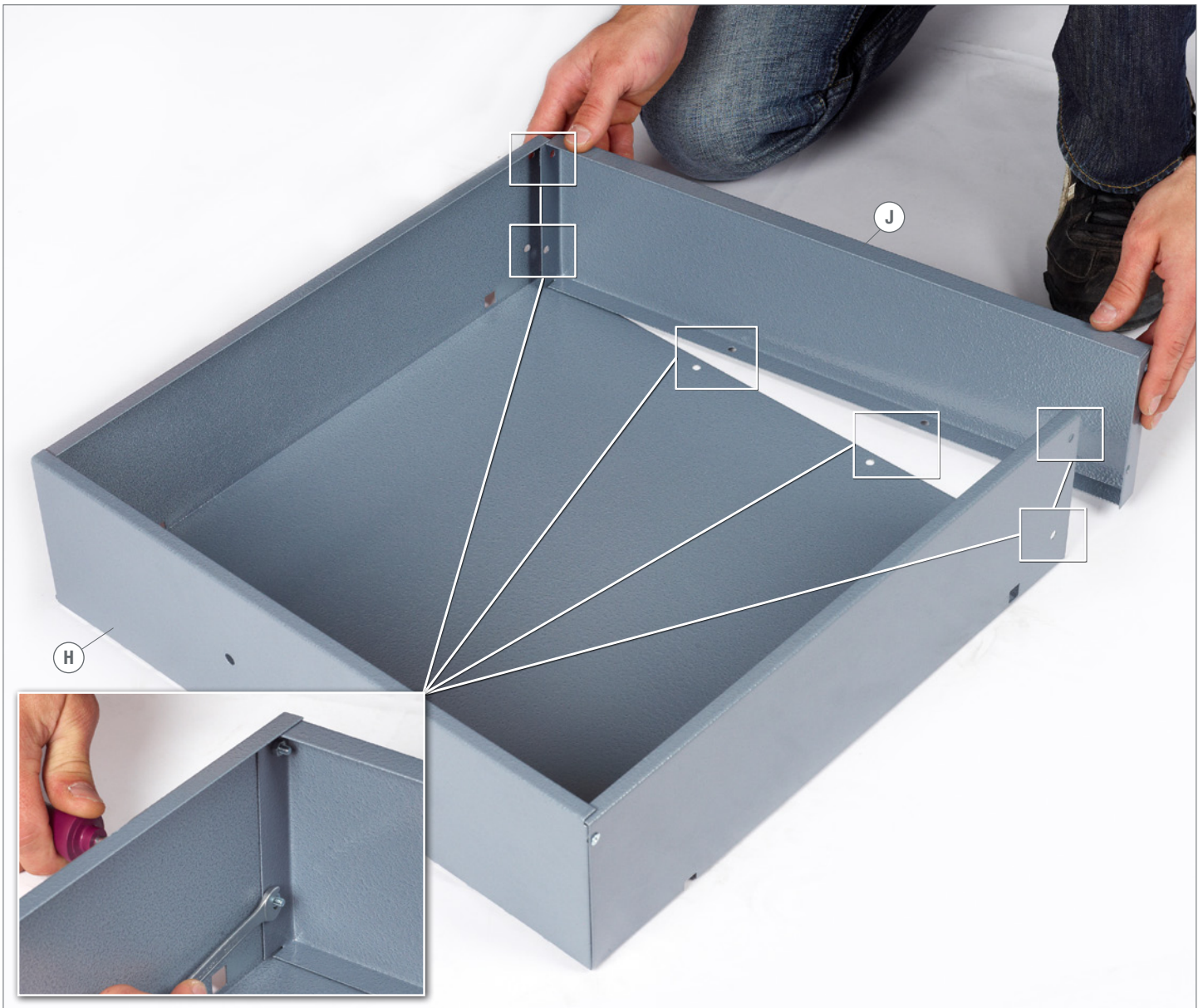

26.

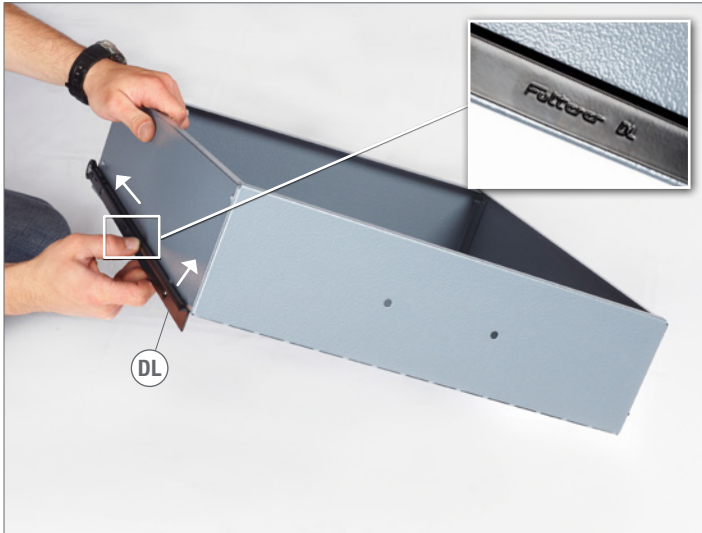

27.

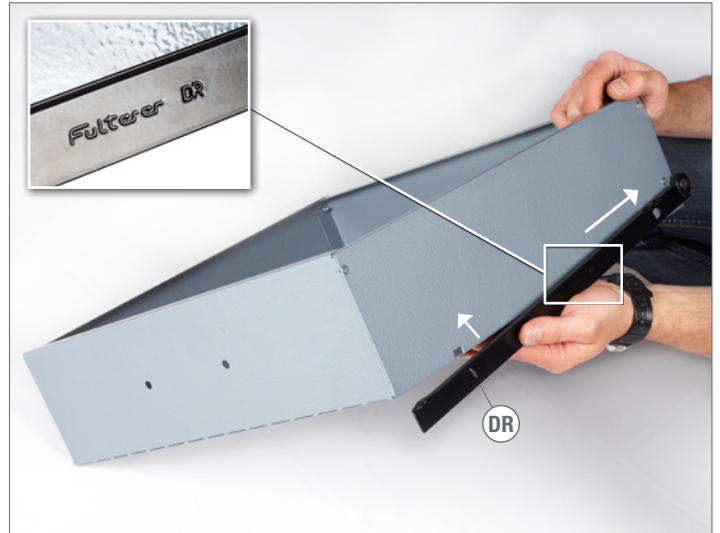

28.



29.

18x KU 4 x 16 9x  ①  PH 2 x 100



30.



31.

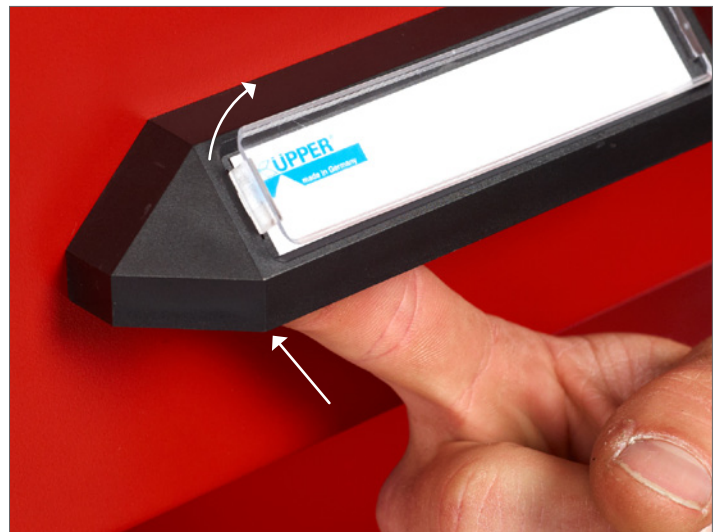



Modell-Nr.

12870